

SANBORN

AIR COMPRESSORS

OPERATOR'S MANUAL

- OPERATION
- MAINTENANCE
- REPAIR PARTS

**SERIES
112A300**

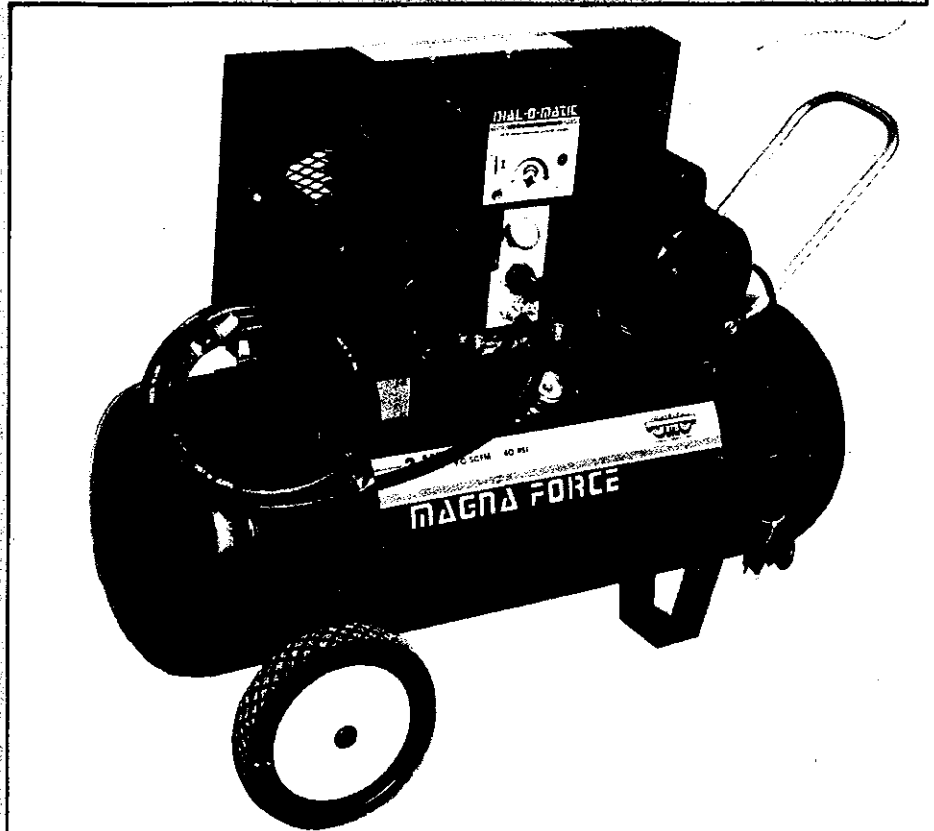

TWIN CYLINDER, ELECTRIC MOTOR AIR COMPRESSOR

CAUTION:

Read the operator's manual carefully before attempting to operate or service this unit! **FAILURE TO COMPLY WITH INSTRUCTIONS COULD RESULT IN PERSONAL INJURY AND/OR PROPERTY DAMAGE!** SANBORN Air Compressors are precision built from the finest materials and with proper care and maintenance will perform efficiently.

Please record the model and serial number and the date the unit was purchased in the spaces below. The model and serial numbers are located on the model plate below the pump. Retain this manual with these numbers for future reference.

Model No. _____

Serial No. _____

Date Purchased _____

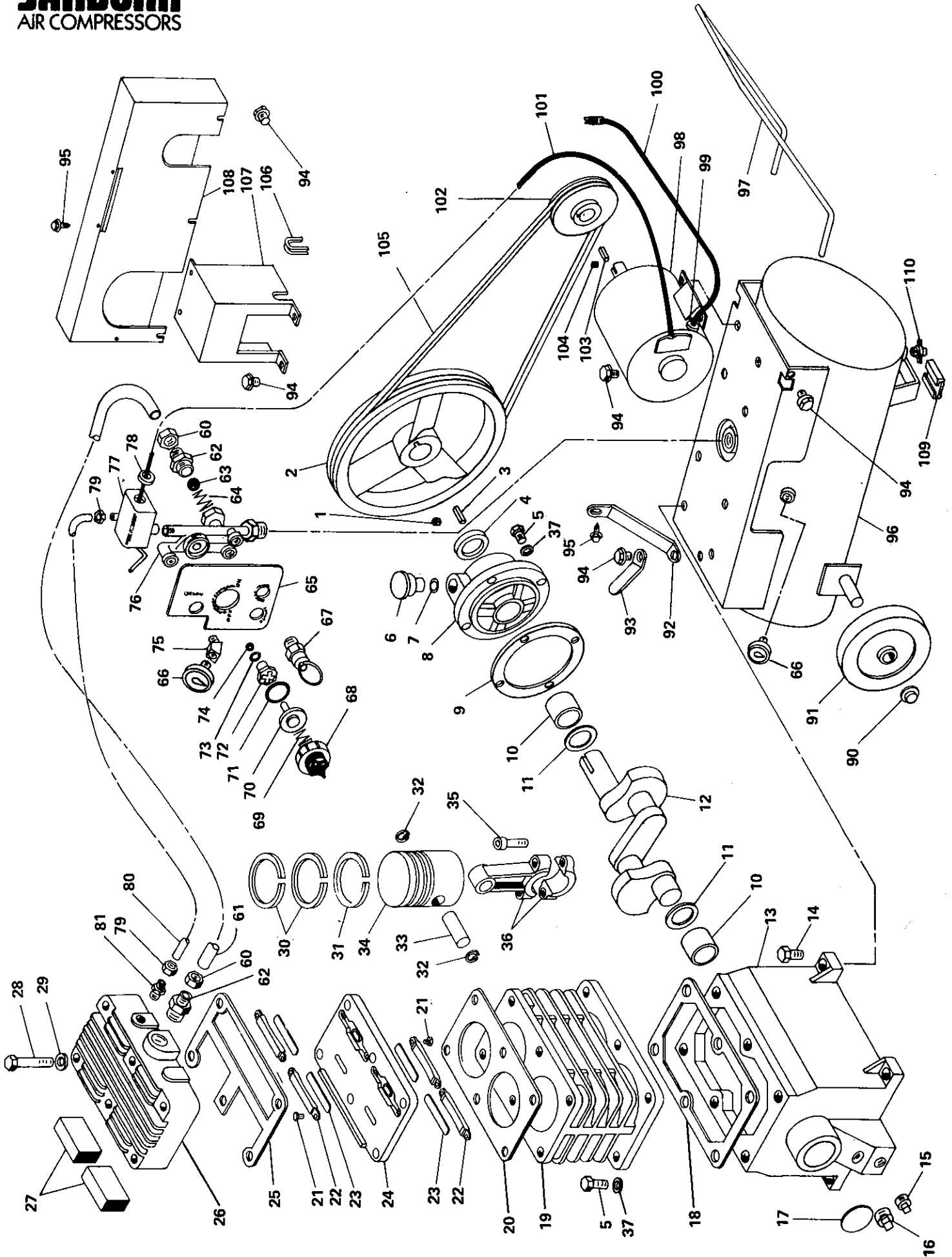

PARTS LIST

SANBORN
AIR COMPRESSORS

REF. NO.	PART NO.	DESCRIPTION	QUANT.
COMPRESSOR PUMP REPLACEMENT PARTS			
1	061-0002	Set screw, 5/16"	1
2	044-0014	10" O.D. Flywheel, B-groove	1
3	146-0001	Key, 3/16" x 1" long	1
4	046-0009	Oil seal	1
5	059-0001	Bolt, 5/16" - 18 x 3/4"	10
6	056-0002	Crankcase breather	1
7	054-0010	O-ring	1
8	045-0010	Bearing carrier	1
9	046-0005	Bearing carrier gasket	1
10	051-0003	Sleeve bearing	2
11	060-0001	Fiber washer	2
12	053-0001	Crankshaft	1
13	049-0005	Crankcase	1
14	059-0010	Bolt, 5/16" - 18 x 1-1/4"	4
15	062-0002	1/8" Oil drain plug	1
16	062-0004	3/8" Oil fill plug	1
17	062-0003	Expansion plug	1
18	046-0006	Cylinder gasket	1
19	050-0008	Cylinder	1
20	046-0013	Head gasket	1
21	061-0035	No. 6-32 stickscrew 1/4" long	8
22	155-0021	Stop bar	4
23	155-0020	Flex-Leaf valve	4
24	043-0073	Valve plate	1
25	046-0014	Valve plate gasket	1
26	042-0007	Head	1
27	019-0015	Inlet filter	2
28	059-0026	Bolt, 3/8" - 16 x 2-1/2"	6
29	060-0014	Gasket washer	1
30	054-0019	Compression ring	4
31	054-0020	Oil control ring	2
32	054-0018	Wrist pin retaining ring	4
33	052-0004	Wrist pin	2
34	048-0008	Piston, 2-5/8"	2
35	059-0004	Bolt, 5/16" - 18 x 1-1/4" (socket head)	4
36	047-0008	Connecting rod	2
37	103-0011	Bolt seal, 5/16" I.D.	10

REF. NO.	PART NO.	DESCRIPTION	QUANT.
TANK ASSEMBLY REPLACEMENT PARTS			
90	033-0001	Hub cap, 1/2" for 10 and 12 gallon portable models	2
90	033-0002	Hub cap, 5/8" for 20, 22 & 30 gal. portable models	2
91	095-0010	Wheel, 8" x 1.75" for 22 & 30 gallon portable models	2
91	095-0001	Wheel, 10" x 1.75" for 20 & 30 gallon ASME, and 22 & 30 gallon non-code models	2
92	114-0006	Belt guard bracket	1
93	114-0005	Hose bracket	1
94	059-0012	Lock bolt, 5/16" - 18 x 1/2"	11
95	061-0005	No. 10 sheet metal screw	3
96	127-0019	10 gallon tank	1
96	151-0001	12 gallon ASME tank	1
96	152-0001	20 gallon ASME tank	1
96	130-0002	22 gallon tank	1
96	131-0001	30 gallon tank (portable)	1
96	153-0001	30 gallon ASME tank (portable)	1
96	131-0003	30 gallon tank (horz. stationary)	1
96	153-0003	30 gallon ASME tank (horz. stationary)	1
96	131-0004	30 gallon tank (vert. stationary)	1
96	153-0005	30 gallon ASME tank (vert. stationary)	1
97	112-0002	Handle (for portable models only)	1
98	160-0006	3 HP motor, 230 volt	1
99	071-0002	Strain relief connector	1
100	026-0011	Power cord, 14/3 x 6', 230 volt, 15 amp for Domestic models	1
100	026-0038	Power cord, 14/3' x 6', 230 volt, 15 amp for CSA models	1
101	026-0013	Interconnecting cord, 14/2 x 34" long	1
102	006-0021	Pulley, 2 1/2" O.D., B-width	1
103	146-0001	Key, 3/16" x 1" long	1
104	061-0006	Set screw, 5/16" - 18 x 3/8"	1
105	008-0023	V-belt, 5L-480	1
106	093-0003	Grommet strip	1
107	117-0002	Manifold cover	1
108	142-0003	Belt guard for Domestic models	1
108	142-0012	Belt guard for CSA models	1
109	094-0002	Vibration isolator (portable models only)	1
110	072-0001	1/4" Petcock (tank drain)	1

DIAL-O-MATIC REPLACEMENT PARTS			
60	058-0016	1/2" Compression nut & sleeve	2
61	145-0028	Transfer tube, 1/2" O.D.	1
62	068-0009	Male connector, 1/2" NPT x 1/2" O.D. tube	2
63	079-0002	Ball seat	1
64	055-0007	Spring <i>033-0009</i>	1
65	106-0001	Face plate	1
66	032-0001	Gauge, 160 PSI, 1/8" back connect	2
66	032-0005	Gauge, 160 PSI, 1/4" back connect for 30 gallon ASME Vertical models	1
66	032-0003	Gauge, 160 PSI, 1/4" bottom connect for 30 gallon non-code models	1
67	136-0012	Pressure relief valve for all Domestic models	1
67	136-0004	125 lb. A.S.M.E. pressure relief valve for all models with an A.S.M.E. tank	1
67	136-0019	Pressure relief valve assembly for all CSA models with non-code tanks	1
68	137-0001	Knob assembly	1
69	055-0005	Regulator spring	1
70	078-0001	Regulator piston	1
71	054-0007	O-ring	1
72	105-0002	Guide	1
73	054-0040	O-ring	1
74	079-0005	Ball, 1/4"	1
75	064-0028	1/8" NPT 45° street elbow	1
76	041-0003	Manifold	1
77	034-0025	Pressure switch for Domestic models	1
77	034-0012	Pressure switch for CSA models	1
78	093-0001	Rubber grommet	1
78	071-0002	Strain relief connector for all CSA models	1
79	058-0017	1/4" compression nut & sleeve	2
80	145-0008	Bleeder tube 1/4" O.D.	1
81	068-0002	Male connector, 1/8" NPT x 1/4" O.D. tube	1

ASSEMBLIES & MISCELLANEOUS PARTS		
040-0020	Pump Assembly, model 112 SANBORN	
165-0014	Overhaul Kit, (includes gasket set, filters, valves with screws and ring set)	
054-0067	Complete set of rings	
046-0153	Complete set of gaskets	
043-0074	Valve plate assembly (ref. nos. 20-25)	
048-0024	Piston assembly (ref. nos. 30-34)	
042-0017	Cylinder head assembly (ref. nos. 20-27 & 29)	
012-0004	Hose, 3/8" x 15' (not shown)	
038-0002	Air chuck (on end of hose)	
018-0007	Air compressor oil, SAE 30 (recommended for use above 20° F., 1 quart)	
018-0008	Air compressor oil, SAE 10 (recommended for use below 20° F., 1 quart)	