

# SCHEMATIC FOR PMP11K3

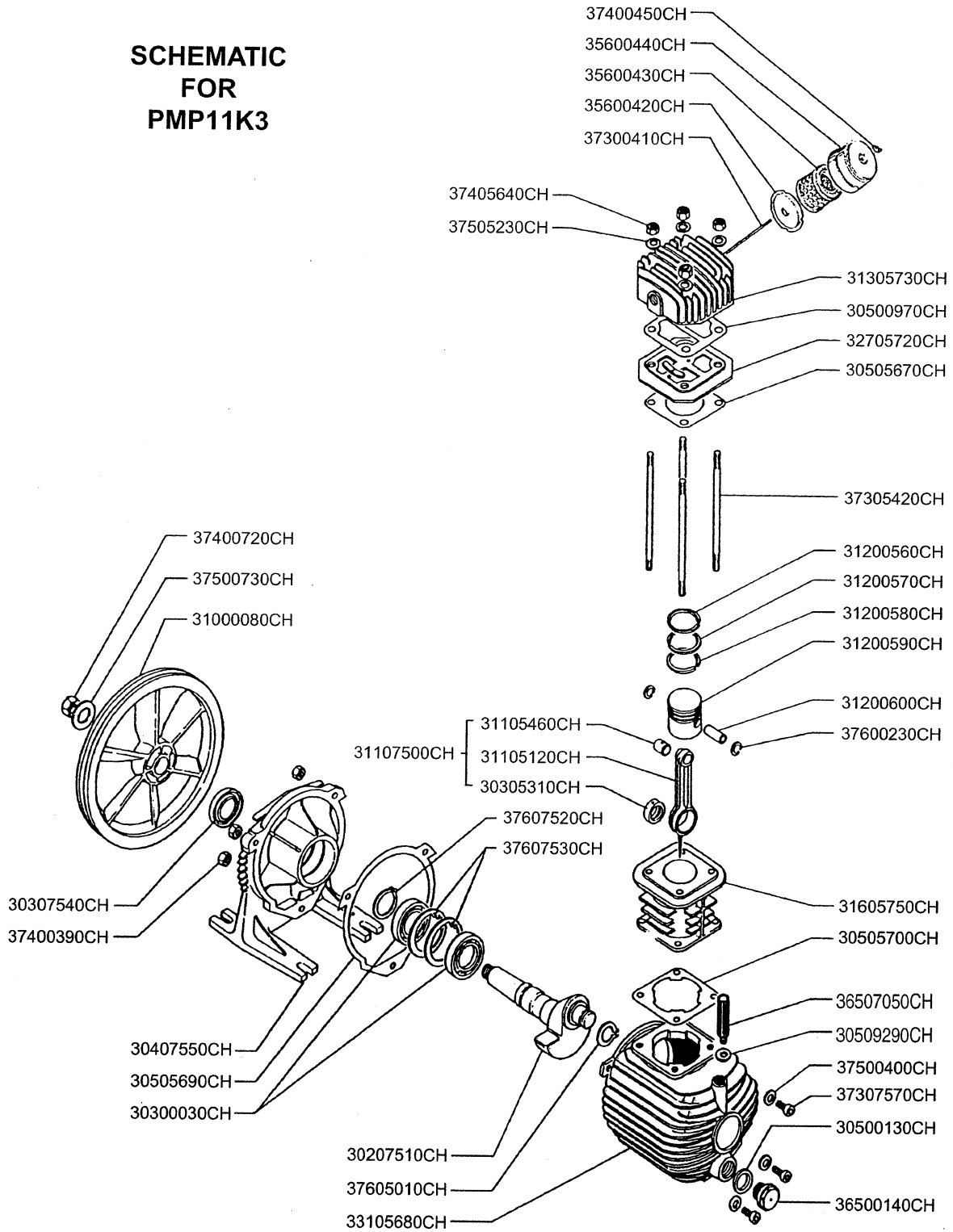



**Associate Engineering Corporation**

606 S. Lake Street, P.O. Box 346  
 Hustisford Wisconsin 53034-0346  
 Phone: 920-349-3281  
 Sales Fax: 920.349.3691 Service Fax: 920.349.8861  
[www.rolair.net](http://www.rolair.net)

**PARTS LIST FOR PMP11K3**

<b>Description</b>	<b>Part #</b>	<b>Qty.</b>
Crankshaft	30207510CH	1
Ball Bearing	30300030CH	2
Bushing	30305310CH	1
Oil Seal	30307540CH	1
Mounting Flange	30407550CH	1
Gasket	30500130CH	1
Gasket	30500970CH	1
Gasket	30505670CH	1
Gasket	30505690CH	1
Gasket	30505700CH	1
O-Ring	30509290CH	1
Flywheel	31000080CH	1
Connecting Rod	31105120CH	1
Bushing*	31105460CH	1
Connecting Rod w/upper bushing	31107500CH	1
Compression Ring	31200560CH	1
Stepped Scraper Ring	31200570CH	1
Slotted Oil Ring	31200580CH	1
Piston	31200590CH	1
Piston Pin	31200600CH	1
Cylinder Head	31305730CH	1
Cylinder	31605750CH	1
Valve Plate Assembly	32705720CH	1
Crankcase	33105680CH	1
Filter Base	35600420CH	1
Filter Element	35600430CH	1
Filter Cover	35600440CH	1
Oil Sight Gauge	36500140CH	1
3/8" Breather/Oil Fill Plug	36507050CH	1
Tension Rod	37300410CH	1
Cylinder/Head Bolt	37305420CH	4
Bolt	37307570CH	3
Nut	37400390CH	3
Wing Nut	37400450CH	1
Nut	37400720CH	1
Nut	37405640CH	4
Washer	37500400CH	3
Washer	37500730CH	1
Washer	37505230CH	4
Snap Ring	37600230CH	2
Snap Ring	37605010CH	1
Snap Ring	37607520CH	1
Snap Ring	37607530CH	2
Ring Set	K3RINGS	1
Gasket Set	K3GASKETS	1

\*Bushing is not machined to fit piston pin if ordered separate from connecting rod.