

SCHEMATIC FOR PMP12K35

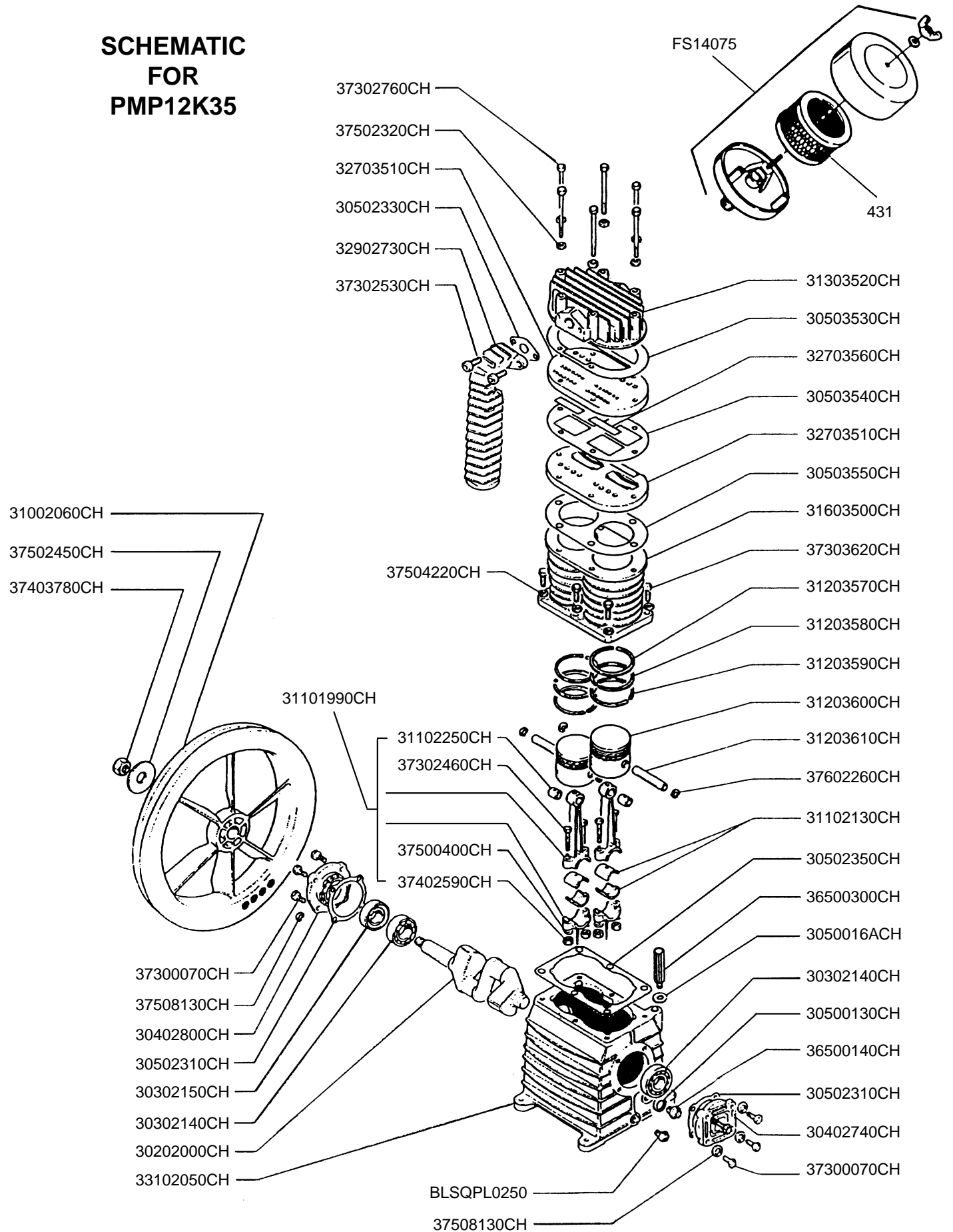

**Associate Engineering Corporation**

606 S. Lake Street P.O. Box 346

Hustisford, Wisconsin 53034-0346

Phone: 920-349-3281

Sales Fax: 920.349.3691 Service Fax: 920.349.8861

www.rolair.net**PARTS LIST FOR PMP12K35**

Description	Part #	Qty.
Crankshaft	30202000CH	1
Ball Bearing	30302140CH	2
Oil Seal	30302150CH	1
Bearing Carrier	30402740CH	1
Bearing Carrier	30402800CH	1
Gasket	30500130CH	1
3/8" Hole Gasket	3050016ACH	1
Gasket	30502350CH	1
Gasket	30502310CH	2
Gasket	30502330CH	1
Gasket	30503530CH	1
Gasket	30503540CH	1
Gasket	30503550CH	1
Flywheel	31002060CH	1
Connecting Rod w/upper bushing	31101990CH	2
Bearing Shell	31102130CH	2
Bushing	31102250CH	2
Compression Ring	31203570CH	2
Stepped Scraper Ring	31203580CH	2
Slotted Oil Ring	31203590CH	2
Piston	31203600CH	2
Piston Pin	31203610CH	2
Cylinder Head	31303520CH	1
Cylinder	31603500CH	1
Valve Plate	32703510CH	2
Valve	32703560CH	8
Aftercooler	32902730CH	1
Crankcase	33102050CH	1
Oil Sight Gauge	36500140CH	1
3/8" Breather/Oil Fill Plug	36500300CH	1
Bolt	37300070CH	8
Bolt	37302460CH	4
Bolt	37302530CH	2
Bolt	37302760CH	6
Bolt	37303620CH	6
Nut	37402590CH	4
Nut	37403780CH	1
Washer	37508130CH	8
Washer	37500400CH	4
Washer	37502320CH	6
Washer	37502450CH	1
Washer	37504220CH	6
Snap Ring	37602260CH	4
Filter Element	431	1
1/4" Square Head Plug	BLSQPL0250	1
Filter Assembly	FS14075	1
Ring Set	K35RINGS	1
Gasket Set	K35GASKETS	1
Valve Plate Assembly	3500VK35	1